

SWTA6301VX-180L/250L

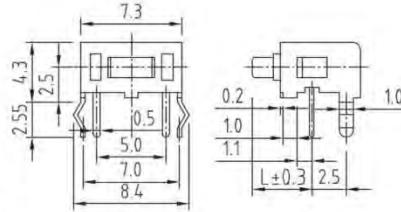

1. Rating : DC 12V. 50mA
2. Travel : 0.25±0.1m/m
3. Operating Force : 180 ±30gf
or 250 ±50gf
4. Contact Resistance : 100m Ω MAX
5. Life : 50,000 or 30,000 Cycles



Part No:	L
SWTA6301V	3.15mm
SWTA6301VA	3.85mm

SWTA6427X-160L



1. Rating : DC 12V. 50mA
2. Travel : 0.2±0.1m/m
3. Operating Force : 160±30gf
4. Contact Resistance : 50m Ω MAX
5. Life : 100,000 Cycles Min

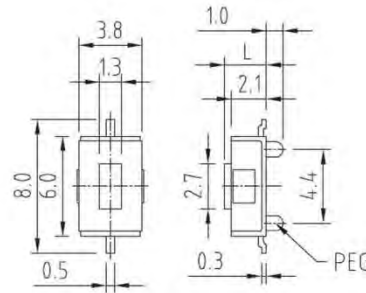

Part No:	L	PEG
SWTA6427	2.5mm	With
SWTA6427A	2.5mm	W/O

SWTA6601HX-130L/160L/250L



1. Rating : DC 12V. 50mA
2. Travel : 0.25±0.1m/m
3. Operating Force : 130 or 160 ±30gf
or 250 ±50gf
4. Contact Resistance : 50m Ω MAX
5. Life : 100,000 Cycles

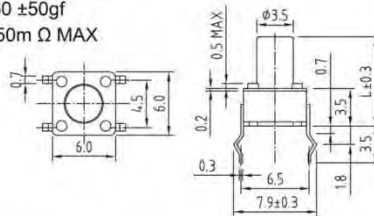

Part No:	L
SWTA6601H	4.3mm
SWTA6601HA	5.0mm
SWTA6601HB	7.0mm
SWTA6601HC	8.0mm
SWTA6601HD	9.5mm
SWTA6601HE	7.3mm
SWTA6601HF	12.5mm
SWTA6601HG	13.5mm

SWTA6601PX-130L/160L/250L



1. Rating : DC 12V. 50mA
2. Travel : 0.25±0.1m/m
3. Operating Force : 130 or 160 ±30gf
or 250 ±50gf
4. Contact Resistance : 50m Ω MAX
5. Life : 100,000 Cycles

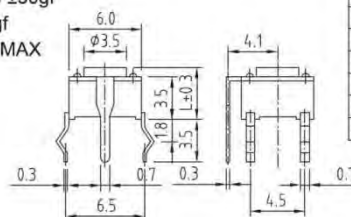

Part No:	L
SWTA6601P	4.3mm
SWTA6601PA	5.0mm
SWTA6601PB	7.0mm
SWTA6601PC	8.0mm
SWTA6601PD	9.5mm
SWTA6601PE	7.3mm
SWTA6601PF	12.5mm
SWTA6601PG	13.5mm

